

# Aluminum Smelters

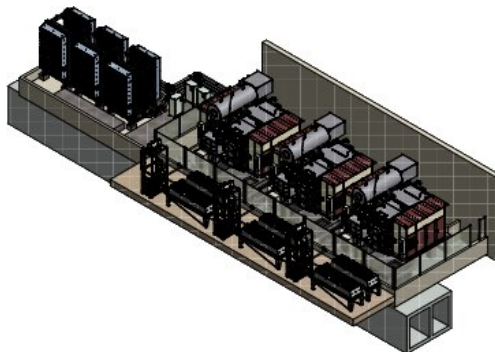

## Transformer Rectifier General Specifications

Standards		ANSI / IEEE / IEC	
		<b>Potline units</b>	<b>Booster and Compensator Units</b>
Three-phase supply voltage main by customer	Vac	to 69000	up to 36000
Three-phase supply voltage on the secondary	Vac	to 2000	up to 200
Maximum power	kVA	65000	25000
Frequency	Hz	50 / 60	50 / 60
Rectifier Connection		Bridge or Star	Bridge or Star
Pulses		6 / 12 / 18 / 24 / 36 and more	6 / 12 / 18 / 24 / 36 and more
Rectifier power section material		Aluminum or Copper	Aluminum or Copper
NLTC or OLTC		no load and on load tap changers	no load and on load tap changers
DC Current	A <sub>dc</sub>	500000	150000
DC Voltage	V <sub>dc</sub>	2000	5-75
Control card type		Digital or Analog, hard wired or OPTO	Digital or Analog, hard wired or OPTO
PLC		Allen Bradely or Siemens, others available. Dial in Modem or Cellular modem for diagnostics	Allen Bradely or Siemens, others available. Dial in Modem or Cellular modem for diagnostics
Accuracy of the constant current control system		±0.5%	±0.5%
Metering		Shunt / LEM / Primary CT	Shunt / LEM / Primary CT
Rectifying elements		Thyristors / Diodes	Thyristors / Diodes
Transformer Cooling		Oil to Water / Oil to air	Air cooled / Oil to Water / Oil to air
Transformer Oil Type		Mineral / FR3 / Silicon	Air / Mineral / FR3 / Silicon
Rectifier Cooling		Deionized Water to water / Deionized Water to air	Deionized Water to water / Deionized Water to air
Installation		indoor or outdoor	indoor or outdoor
Rectifier Enclosure Type		Compact / Semi-walk in / Walk in	Compact / Semi-walk in / Walk in
Transformer Manufacturer		Neeltran	Neeltran
Rectifier Manufacturer		Neeltran	Neeltran
Line Up Testing Available		Combined Test at Neeltran Factory	Yes at Neeltran

**Neeltran, Inc.**

860.350.5964 · 860.350.5024 fax | 71 Pickett District Road | New Milford, CT 06776, USA